

SPENCE WILLARD



Land to the South of Sandy Lane, Nr Gatcombe, Isle of Wight

One paddock (approx 2.9 acres) of agricultural land set in picturesque surroundings near Gatcombe, currently used for grazing

VIEWING

COWES@SPENCEWILLARD.CO.UK 01983 200880 WWW.SPENCEWILLARD.CO.UK

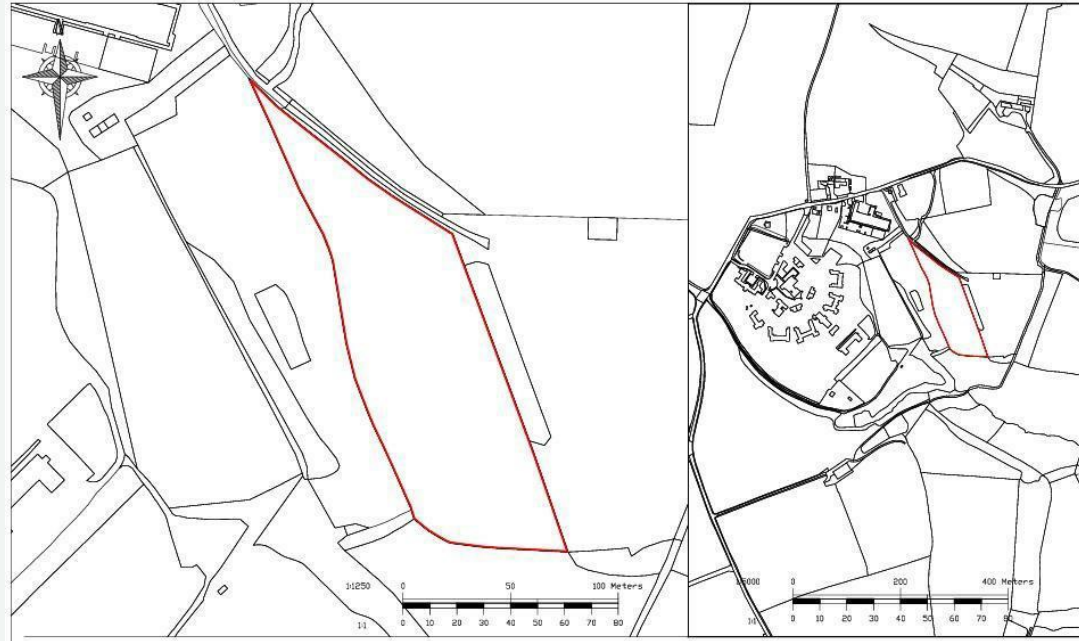

Land to the South of Sandy Lane

Situated in a quiet rural location towards the end of Sandy Lane with access along a private lane. A paddock of approximately 2.9 acres.

SERVICES - There is no direct water connection, however facilities are nearby.

POSTCODE - PO30 3EA

TENURE - Freehold

NOTE - The Vendor of this property is related to a staff member of Spence Willard

VIEWINGS - Strictly by appointment with sole agents, Spence Willard

SPENCEWILLARD.CO.UK

IMPORTANT NOTICE: 1. Particulars: These particulars are not an offer or contract, nor part of one. You should not rely on statements by Spence Willard in the particulars or by word of mouth or in writing ('information') as being factually accurate about the property, its condition or its value. Neither Spence Willard nor any joint agent has any authority to make any representations about the property, and accordingly any information given is entirely without responsibility on the part of the agents, seller(s) or lessor(s). 2. Photos etc: The photographs show only certain parts of the property as they appeared at the time they were taken. Areas, measurements and distances given are approximate only. 3. Regulations etc: Any reference to alterations to, or use of, any part of the property does not mean that any necessary planning, building regulations or other consent has been obtained. A buyer or lessee must find out by inspection or in other ways that these matters have been properly dealt with and that all information is correct. 4. VAT: The VAT position relating to the property may change without notice.